

ROAD MAP



SITE LOCATION

EXHIBIT 3 - SITE C GENERAL PLANS

REPLACEMENT OF SOUTHERN AVENUE BUS GARAGE PRINCE GEORGE'S COUNTY, MD

<u>DRAWING NO.</u>	<u>DRAWING DESCRIPTION</u>
C-001	COVER SHEET
A-001	EXISTING SITE CONDITIONS
A-101	OVERALL SITE PLAN
A-102	BUS PARKING AND FUELING LEVEL PLAN
A-103	MAINTENANCE DECK LEVEL PLAN
A-104	EMPLOYEE PARKING DECK LEVEL PLAN
A-105	MAINTENANCE BUILDING
A-106	FUEL AND WASH BUILDING
A-201	OPERATIONS & RETAIL PLANS
A-202	BUILDING ELEVATIONS
A-203	MAINTENANCE BUILDING ELEVATIONS
A-204	F&W / R&O BUILDING ELEVATIONS
A-301	SITE SECTIONS
A-302	3D VIEWS
A-303	3D VIEWS
A-304	STREETSCAPE VIEWS
A-305	STREETSCAPE VIEWS

BIRDEYE OF EXISTING CONDITIONS



DESIGNED _____ DATE _____		REFERENCE DRAWINGS		REVISIONS		WASHINGTON METROPOLITAN AREA TRANSIT AUTHORITY		HALF SIZE PRINT	CONTRACT NO.
DRAWN _____ DATE _____		NUMBER	DESCRIPTION	DATE	BY	DESCRIPTION	REPLACEMENT OF SOUTHERN AVE BUS GARAGE PRINCE GEORGE'S COUNTY, MD EXHIBIT 3 COVER		
CHECKED _____ DATE _____							SCALE: NOT TO SCALE		
APPROVED _____ DATE _____							DRAWING NO.		SITE C
									

Electronic copies once printed are UNCONTROLLED and may become outdated. Refer to the electronic documents in ProjectShare for current revisions.

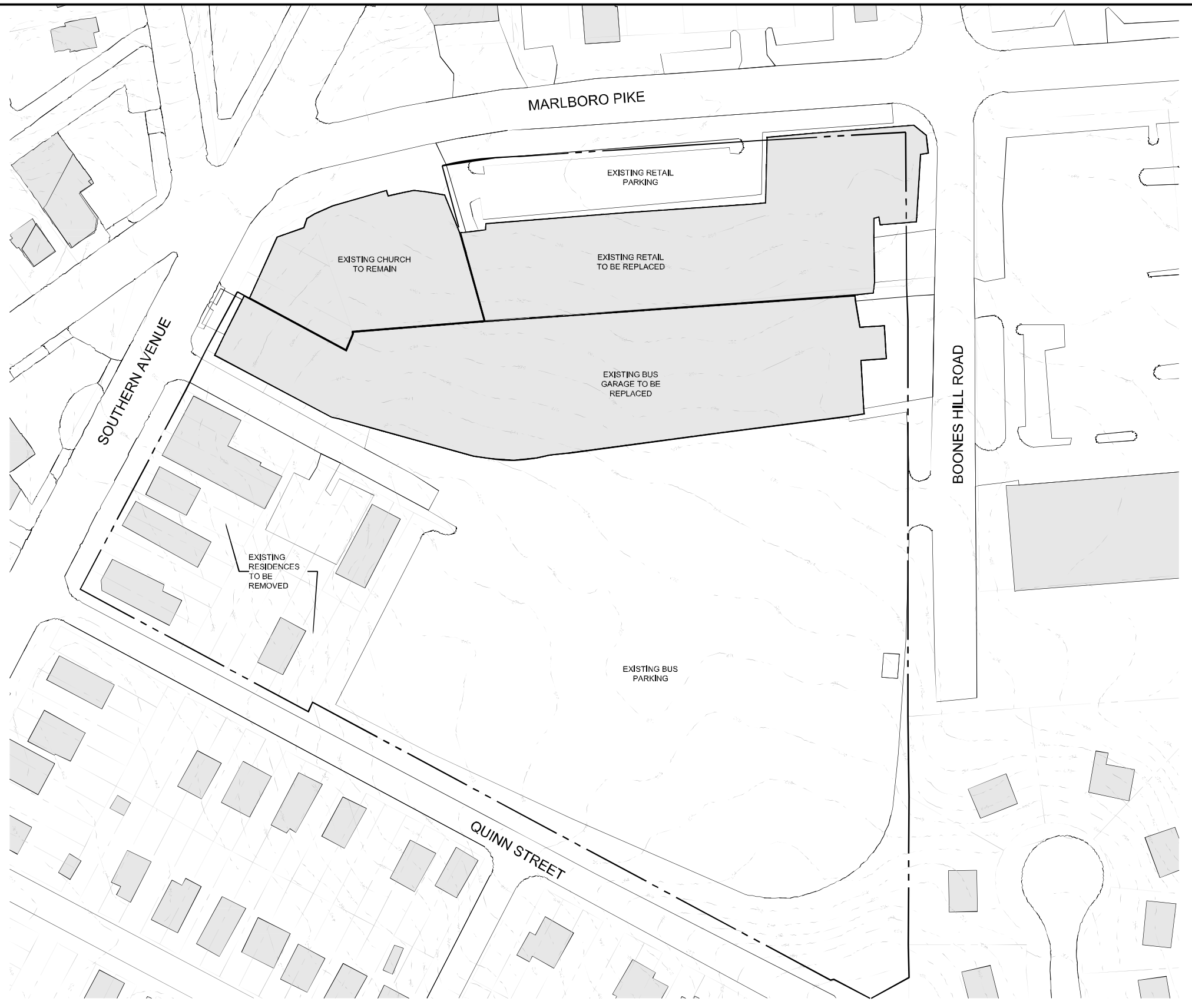

8/23/2011 1:55:09 AM rlf: P:3:n

ORIGINATORS		REFERENCE DRAWINGS		REVISIONS		WASHINGTON METROPOLITAN AREA TRANSIT AUTHORITY		CONTRACT NO.:	
DRAWN	ASI	03/21/11	NUMBER	DESCRIPTION	DATE	BY	DESCRIPTION	HALF-SIZE PRINT	
								SOUTHERN AVE. BUS GARAGE	
DESIGNED	MJP	03/21/11						SITE C - PRINCE GEORGE'S COUNTY	
CHECKED	ASI	03/21/11						EXISTING SITE CONDITIONS	
APPROVED								SCALE:	DRAWING NO.:
								1" = 50'-0"	C-001
									SITE C

PB
125 YEARS

PB Americas, Inc.
1831 CHESTNUT ST., 7TH FLOOR
SAINT LOUIS, MISSOURI 63103
TEL: (314) 421-1476
FAX: (314) 421-5664



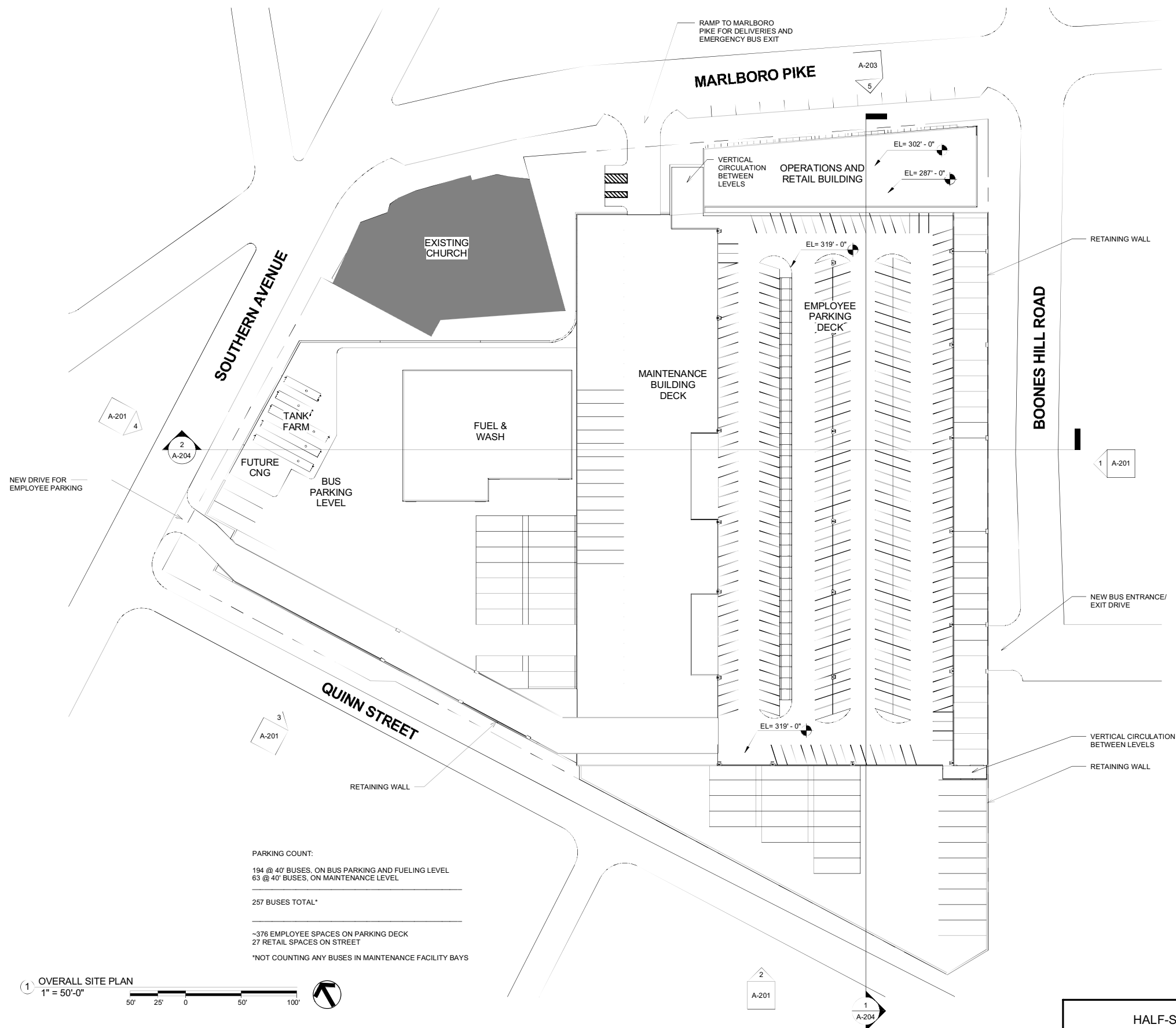

PARKING COUNT:
 194 @ 40' BUSES, ON BUS PARKING AND FUELING LEVEL
 63 @ 40' BUSES, ON MAINTENANCE LEVEL
 257 BUSES TOTAL*

~376 EMPLOYEE SPACES ON PARKING DECK
 27 RETAIL SPACES ON STREET
 *NOT COUNTING ANY BUSES IN MAINTENANCE FACILITY BAYS

1 OVERALL SITE PLAN
 1" = 50'-0"

WASHINGTON METROPOLITAN AREA TRANSIT AUTHORITY

PB PB Americas, Inc.
 1831 CHESTNUT ST., 7TH FLOOR
 SAINT LOUIS, MISSOURI 63103
 TEL: (314) 421-1476
 FAX: (314) 421-5664



HALF-SIZE PRINT		CONTRACT NO.:	
SOUTHERN AVE. BUS GARAGE SITE C - PRINCE GEORGE'S COUNTY			
OVERALL SITE PLAN			
SCALE: 1" = 50'-0"	DRAWING NO.:	A-001	SITE C

ORIGINATORS		REFERENCE DRAWINGS		REVISIONS		
DATE	ORIGINATOR	NUMBER	DESCRIPTION	DATE	BY	DESCRIPTION
03/21/11	AJF					
03/21/11	AJF					
03/21/11	MGC					
03/21/11	MGC					

Electronic copies are provided as UNCONTROLLED and may become outdated. Refer to the electronic documents in ProjectSolve for current revisions.

C:\2006\projects\036_Southern Ave Bus Garage\Drawings\WMAIA_Corridor\173333\A WMAIA_Southern Ave_Corridor_A1-101.dwg

3/11/2011 3:24:40 PM

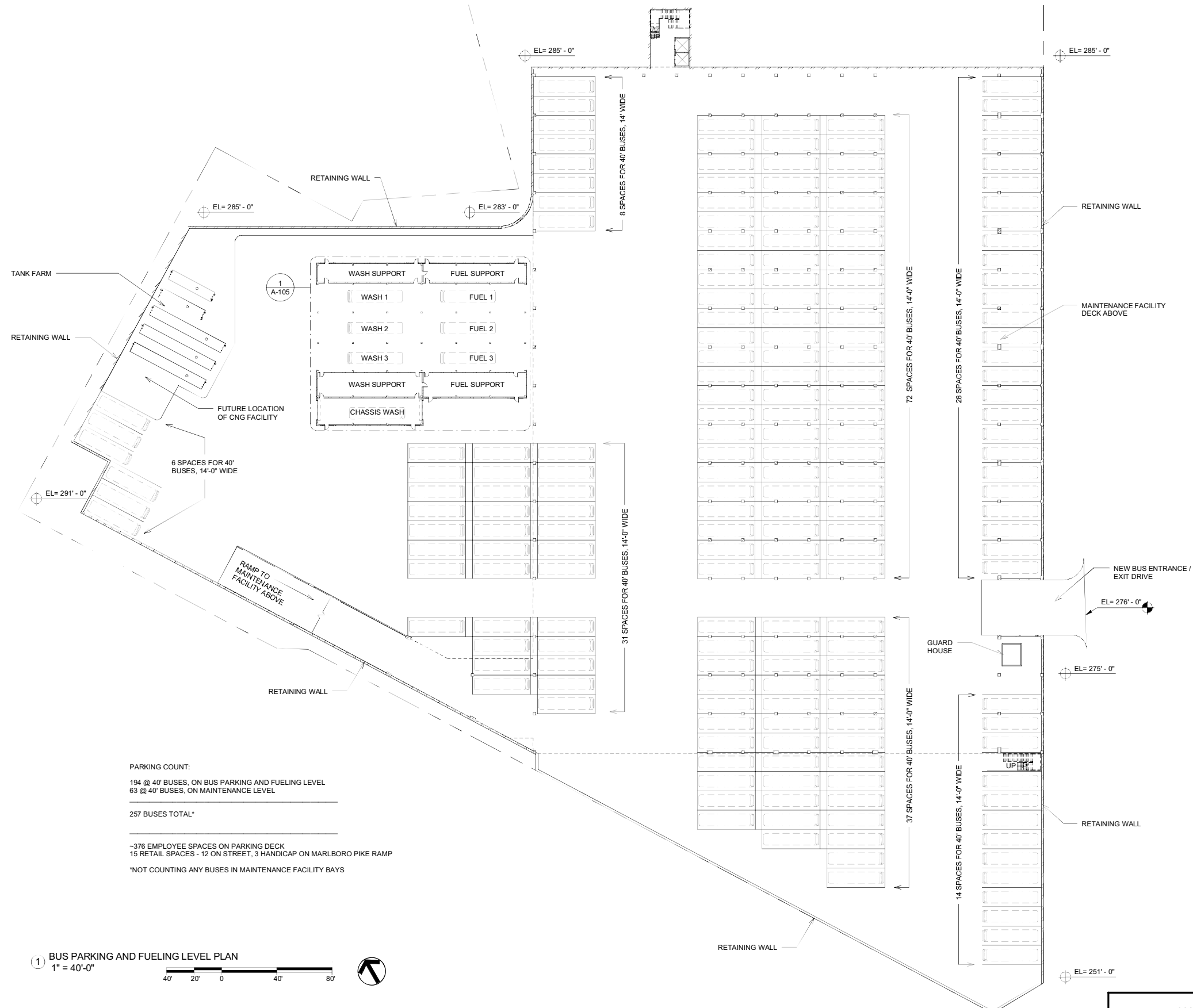

PARKING COUNT:
 194 @ 40' BUSES, ON BUS PARKING AND FUELING LEVEL
 63 @ 40' BUSES, ON MAINTENANCE LEVEL

 257 BUSES TOTAL*

 ~376 EMPLOYEE SPACES ON PARKING DECK
 15 RETAIL SPACES - 12 ON STREET, 3 HANDICAP ON MARLBORO PIKE RAMP
 *NOT COUNTING ANY BUSES IN MAINTENANCE FACILITY BAYS

1 BUS PARKING AND FUELING LEVEL PLAN
 1" = 40'-0"

ORIGINATORS		REFERENCE DRAWINGS		REVISIONS		
DATE	BY	NUMBER	DESCRIPTION	DATE	BY	DESCRIPTION
03/21/11	AJF					
03/21/11	AJF					
03/21/11	MGC					
03/21/11	MGC					

WASHINGTON METROPOLITAN AREA TRANSIT AUTHORITY  PB Americas, Inc. 1831 CHESTNUT ST., 7TH FLOOR SAINT LOUIS, MISSOURI 63103 TEL: (314) 421-1476 FAX: (314) 421-5664				HALF-SIZE PRINT SOUTHERN AVE. BUS GARAGE SITE C - PRINCE GEORGE'S COUNTY BUS PARKING AND FUELING LEVEL PLAN SCALE: 1" = 40'-0" DRAWING NO.: A-101 SITE C		CONTRACT NO.:	
--	--	---	--	--	--	---------------	--

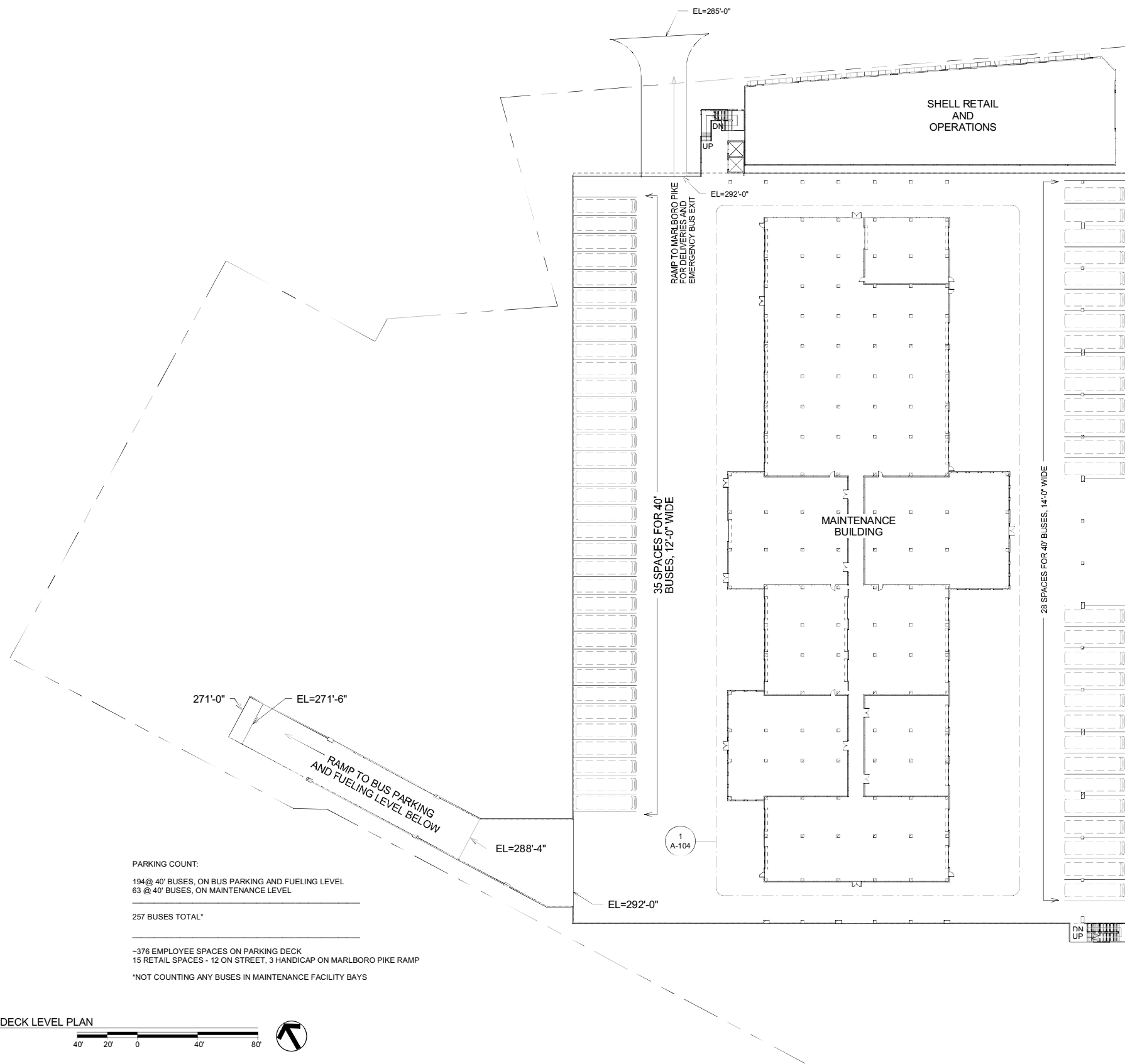

PARKING COUNT:
 194 @ 40' BUSES, ON BUS PARKING AND FUELING LEVEL
 63 @ 40' BUSES, ON MAINTENANCE LEVEL

 257 BUSES TOTAL*

~376 EMPLOYEE SPACES ON PARKING DECK
 15 RETAIL SPACES - 12 ON STREET, 3 HANDICAP ON MARLBORO PIKE RAMP
 *NOT COUNTING ANY BUSES IN MAINTENANCE FACILITY BAYS

1 MAINTENANCE DECK LEVEL PLAN
 1" = 40'-0"

ORIGINATORS		REFERENCE DRAWINGS		REVISIONS		
DATE	BY	NUMBER	DESCRIPTION	DATE	BY	DESCRIPTION
03/21/11	AJF					
03/21/11	AJF					
03/21/11	MGC					
03/21/11	MGC					

WASHINGTON METROPOLITAN AREA TRANSIT AUTHORITY

PB PB Americas, Inc.
 1831 CHESTNUT ST., 7TH FLOOR
 SAINT LOUIS, MISSOURI 63103
 TEL: (314) 421-1476
 FAX: (314) 421-5664



HALF-SIZE PRINT		CONTRACT NO.:	
SOUTHERN AVE. BUS GARAGE SITE C - PRINCE GEORGE'S COUNTY			
MAINTENANCE DECK LEVEL PLAN			
SCALE: 1" = 40'-0"	DRAWING NO.:	A-102	SITE C

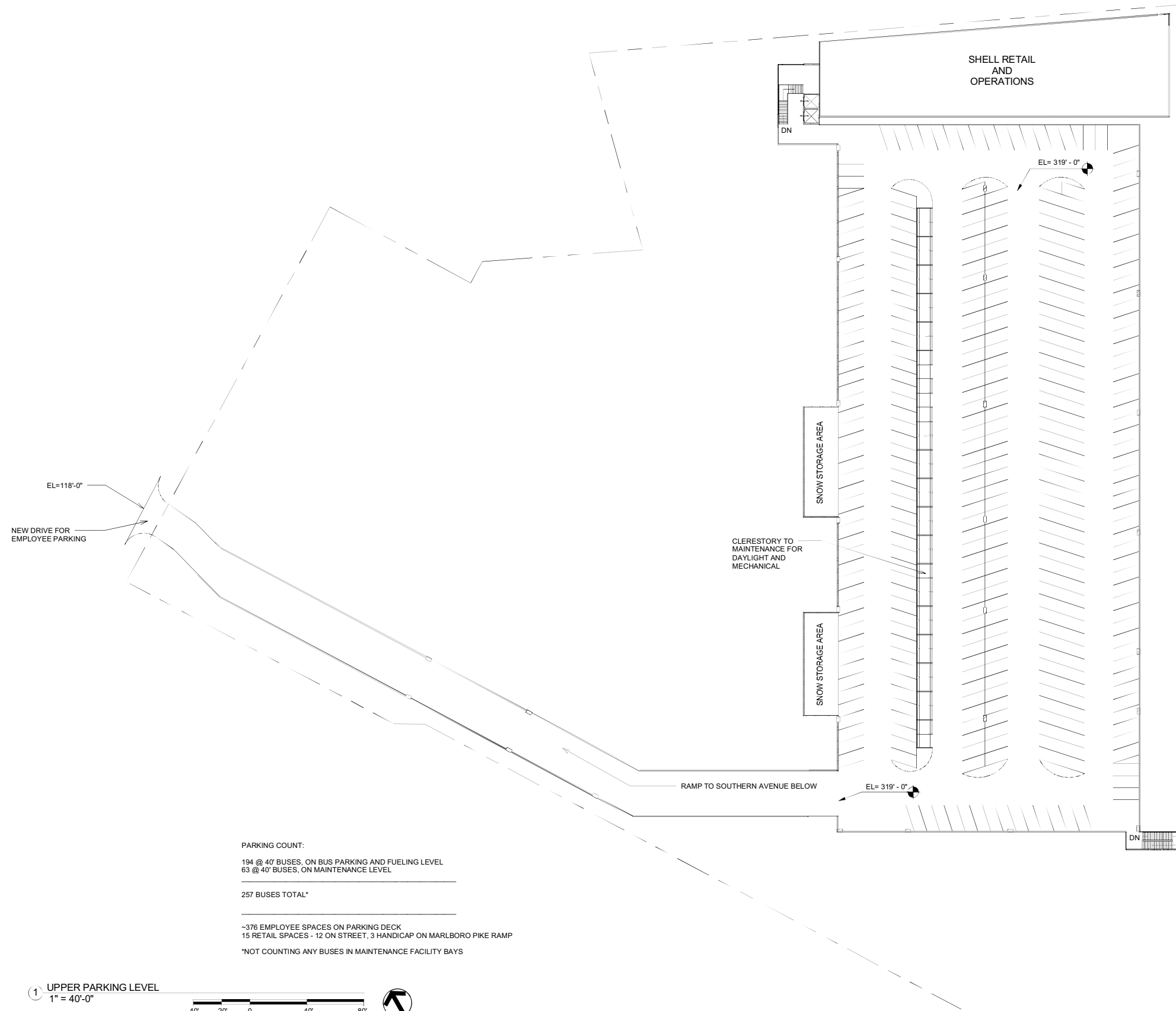

PARKING COUNT:
 194 @ 40' BUSES, ON BUS PARKING AND FUELING LEVEL
 63 @ 40' BUSES, ON MAINTENANCE LEVEL

 257 BUSES TOTAL*

~376 EMPLOYEE SPACES ON PARKING DECK
 15 RETAIL SPACES - 12 ON STREET, 3 HANDICAP ON MARLBORO PIKE RAMP
 *NOT COUNTING ANY BUSES IN MAINTENANCE FACILITY BAYS

1 UPPER PARKING LEVEL
 1" = 40'-0"

HALF-SIZE PRINT		CONTRACT NO.:
SOUTHERN AVE. BUS GARAGE SITE C - PRINCE GEORGE'S COUNTY		
EMPLOYEE PARKING DECK LEVEL PLAN		
SCALE: 1" = 40'-0"	DRAWING NO.:	SITE C

ORIGINATORS		REFERENCE DRAWINGS		REVISIONS		
DATE	ORIGINATOR	NUMBER	DESCRIPTION	DATE	BY	DESCRIPTION
03/21/11	AJF					
03/21/11	AJF					
03/21/11	MGC					
03/21/11	MGC					

WASHINGTON METROPOLITAN AREA TRANSIT AUTHORITY



PB America, Inc.
 1831 CHESTNUT ST., 7TH FLOOR
 SAINT LOUIS, MISSOURI 63103
 TEL: (314) 421-1476
 FAX: (314) 421-5664



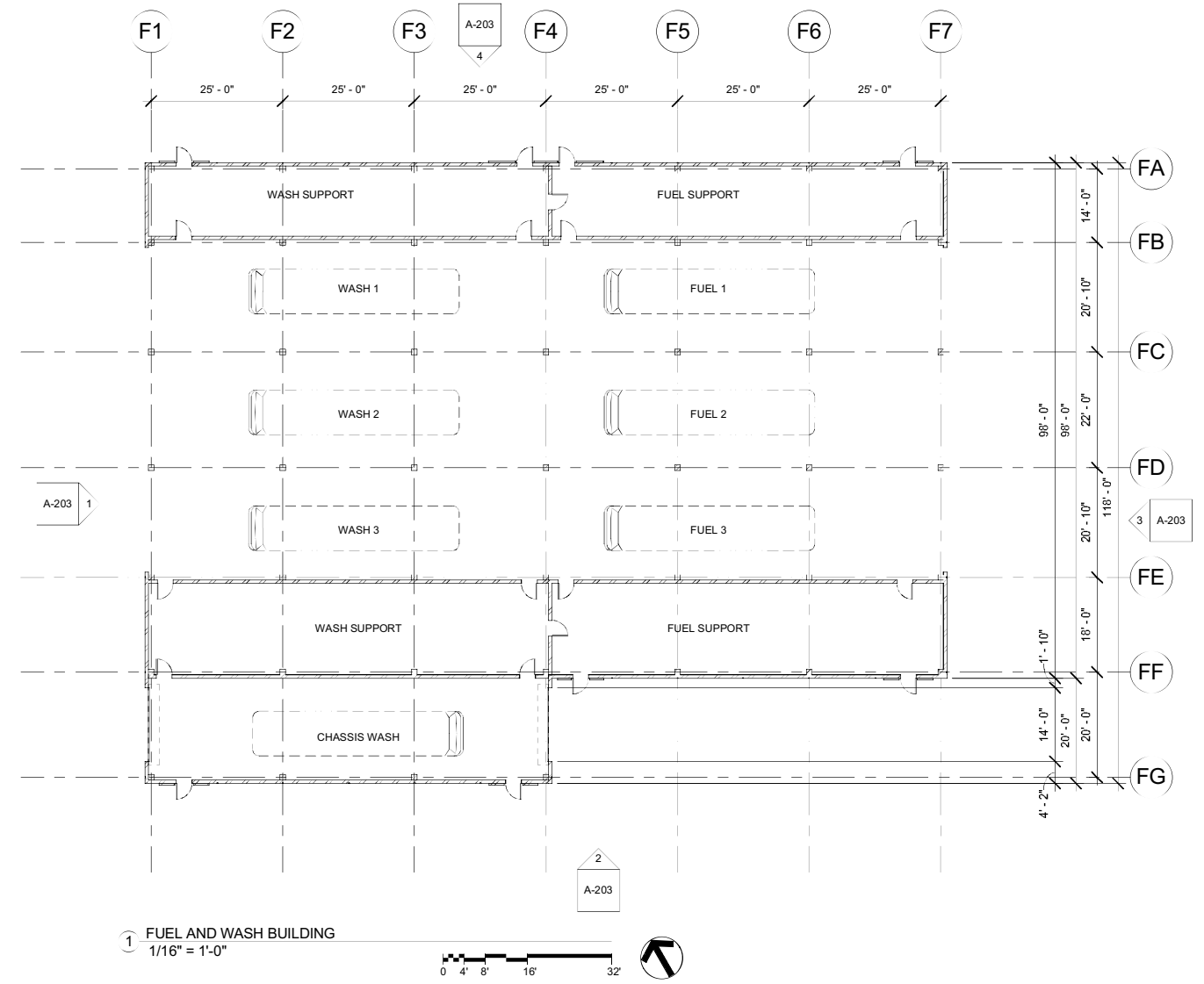

1 FUEL AND WASH BUILDING
1/16" = 1'-0"

WASHINGTON METROPOLITAN AREA TRANSIT AUTHORITY

PB 125 YEARS
PB Americas, Inc.
 1831 CHESTNUT ST., 7TH FLOOR
 SAINT LOUIS, MISSOURI 63103
 TEL: (314) 421-1476
 FAX: (314) 421-5664



HALF-SIZE PRINT		CONTRACT NO.:	
SOUTHERN AVE. BUS GARAGE SITE C - PRINCE GEORGE'S COUNTY			
FUEL AND WASH BUILDING			
SCALE: 1/16" = 1'-0"	DRAWING NO.:	A-105	SITE C



1 NORTHEAST CORNER
12" = 1'-0"



2 LOOKING EAST ALONG MARLBORO PIKE
12" = 1'-0"



3 RETAIL STREETScape
12" = 1'-0"



4 LOOKING EAST ALONG MARLBORO PIKE
12" = 1'-0"

ORIGINATORS		REFERENCE DRAWINGS		REVISIONS		
DATE	BY	NUMBER	DESCRIPTION	DATE	BY	DESCRIPTION
03/21/11	LM					
03/21/11	LM					
03/21/11	MGC					
03/21/11	MGC					

WASHINGTON METROPOLITAN AREA TRANSIT AUTHORITY

PB PB Americas, Inc.
1831 CHESTNUT ST., 7TH FLOOR
SAINT LOUIS, MISSOURI 63103
TEL: (314) 421-1476
FAX: (314) 421-5664



HALF-SIZE PRINT		CONTRACT NO.:
SOUTHERN AVE. BUS GARAGE SITE C - PRINCE GEORGE'S COUNTY		
STREETSCAPE VIEWS		
SCALE: 12" = 1'-0"	DRAWING NO.:	SITE C
	A-303	

C:\2006\projects\eng\Stations\Prince Georges\WMA\A_Southern_Hill_Corridor\111117A_WMA_Southern_Hill_Corridor_111117A.dwg
 3/11/2011 11:13 AM
 Electronic copies are provided as UNCONTROLLED and may become outdated. Refer to the electronic documents in ProjectSolve for current revisions.



1 RETAIL AND OPERATIONS BUILDING
12" = 1'-0"



2 MARLBORO PIKE AND BOONES HILL
12" = 1'-0"



3 STREETScape LOOKING NORTHWEST
12" = 1'-0"



4 STREETScape
12" = 1'-0"

ORIGINATORS		REFERENCE DRAWINGS		REVISIONS		
LM	03/21/11	NUMBER	DESCRIPTION	DATE	BY	DESCRIPTION
DRAWN	LM	03/21/11				
DESIGNED	MGC	03/21/11				
CHECKED	MGC	03/21/11				
APPROVED						

WASHINGTON METROPOLITAN AREA TRANSIT AUTHORITY



PB Americas, Inc.
1831 CHESTNUT ST., 7TH FLOOR
SAINT LOUIS, MISSOURI 63103
TEL: (314) 421-1476
FAX: (314) 421-5664



HALF-SIZE PRINT		CONTRACT NO.:	
SOUTHERN AVE. BUS GARAGE SITE C - PRINCE GEORGE'S COUNTY			
STREETScape VIEWS			
SCALE:	DRAWING NO.:		
12" = 1'-0"	A-304	SITE C	

